

16" FLEXWING GLIDER - ASSEMBLY INSTRUCTIONS IN 3 STEPS

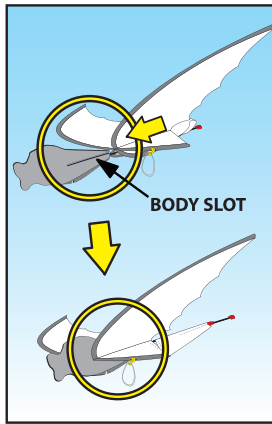

1 Main & Lower Wings Assembly: Slide the Main and Lower Wings into the Body Slot.

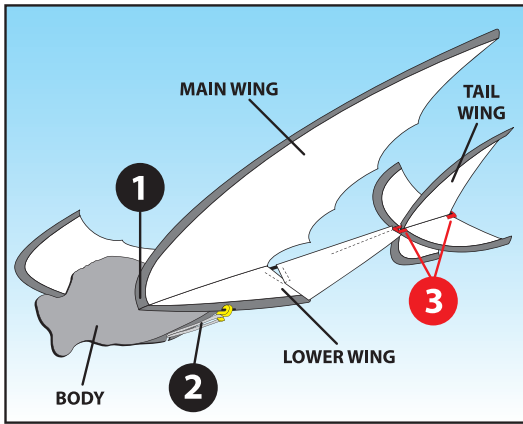
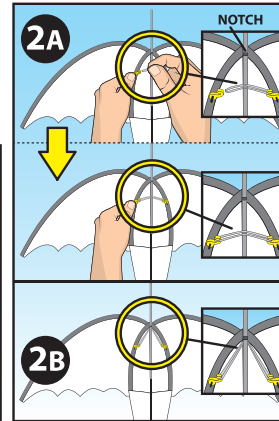

2A Lower Wing Assembly: Your next step is to attach the Lower Wing Support Rubber Band under the Lower Wing of the glider. Attach the Rubber Band to the opposite side of the Lower Wing.

2B Secure the Rubber Band by sliding it into the Notch located on the body.

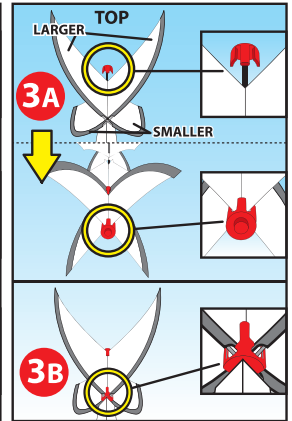

3A Tail Wing Assembly: Form an X with the Tail Wing. Slide under the Rear Center Peg (Red). The Smaller Bottom wings go under the Left and Right Rear Peg (Red).

3B Repeat steps for the Front Center Peg (Red). Secure the Fiberglass Wing Edge into the Notches.

THROWING

EASY TO THROW INDOORS AND OUTDOORS.

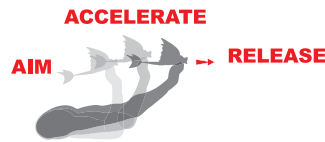
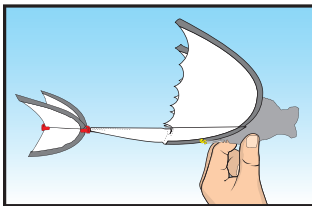

1. Pinch with your index and thumb the lower part of the body and keep wings level.
2. Throw the glider as if you were throwing a Dart.

WARNING: IF THROWING INDOORS, BE SURE TO REMOVE ANY BREAKABLE ITEMS.

FOR MORE TECHNICAL SUPPORT GO TO WWW.XGLIDERS.COM

TROUBLESHOOTING

IF IT'S TURNING LEFT, RIGHT OR IF IT'S DIVING

- CHECK TO MAKE SURE TAIL WING IS PROPERLY ASSEMBLED.
- RESET THE MAIN AND LOWER WINGS LOCATION BY MOVING THEM BACK THEN FORWARD TO THE FRONT OF THE BODY SLOT.
- REPLACE THE OLD RUBBER BAND WITH A NEW ONE.

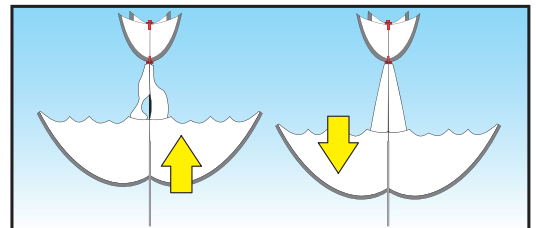

Please take the following warnings seriously to keep people, animals, property and FlexWing™ safe:

Do not aim your FlexWing™ at people or animals. Only fly your FlexWing™ in large open outdoor areas, away from people and animals. If throwing indoors, be sure to remove any breakable items. Never fly your FlexWing™ near roads, power lines, windows or any hard surface you don't want to crash into. Do not fly when it's too windy or you may lose control and crash, causing injury or damage. Use caution; make sure people around you know you are playing with a FlexWing™. Never attempt to recover your FlexWing™ from power lines. Adult supervision recommended.